

(1) SMR Code	(2) Federal Stock Number	(3) DESCRIPTION	(4) UNIT	(5) Qty	(6) 30-day DS maint	(7) 30-day GS maint	(8) 1-yr Depot	(9) Illustration	(10) Figure No.	(b) Item No.		
Reference Number & Mfr. Code			Usable On Code			(a) 1-20	(b) 21-50	(c) 51-100	(a) 1-20	(b) 21-50	(c) 51-100	gcy
0801-POWER TRANSFER AND FINAL DRIVE ASSEMBLIES-CONTINUED												
P-F	2520-033-6017	GEAR,HELICAL: HIGH RANGE INTERMEDIATE SHAFT 7346766 (19207)	A	EA	1	*	*	*	*	*	*	8 10 54 22
P-F	2520-734-6772	SHAFT, INTERMEDIATE: 7346772 (19207)	A	EA	1	*	*	*	*	*	*	8 10 54 23
P-F	5315-850-7038	KEY,WOODRUFF: INTERMEDIATE SHAFT MS35756-105 (96906)	A	EA	2	*	*	*	*	*	*	6 10 54 24
P-F	2520-734-6765	GEAR,HELICAL: LOW RANGE 7346765 (19207)	A	EA	1	*	*	*	*	*	*	8 10 54 25
P-F	5340-737-5284	RING,RETAINING: INTERMEDIATE SHAFT 7375284 (19207)	A	EA	1	*	*	*	*	*	*	6 10 54 26
P-F	2520-734-6767	GEAR,HELICAL: INTERMEDIATE SHAFT 7346767 (19207)	A	EA	1	*	*	*	*	*	*	8 10 54 27
P-F	2520-737-5289	FORK,DECLUTCH: FRONT AXLE OUTPUT SHAFT 7375289 (19207)	A	EA	1	*	*	*	*	*	*	8 10 55 1
P-F	2520-734-6803	SHAFT: FRONT AXLE SHIFTER DECLUTCH 7346803 (19207)	A	EA	1	*	*	*	*	*	*	8 10 55 2
P-F	2520-737-5282	PACKING,PREFORMED: FRONT AXLE DECLUTCH SHIFTER 7375282 (19207)	A	EA	1	*	*	*	*	*	*	8 10 55 3
P-F	5310-188-4195	WASHER,FLAT: FRONT AXLE DECLUTCH SHIFTER 1263 (76894)	A	EA	1	*	*	*	*	*	*	6 10 55 4
P-F	2520-734-6756	CYLINDER,AIR TRANSFER: DECLUTCH SHIFTER FORK 7346756 (19207)	A	EA	1	*	*	*	*	*	*	8 10 55 5
X1		RING: CYLINDER PISTON 8758296 (19207)	A		2							55 6
X1		WASHER,PLAIN: SPRING RETAINER MSP-4X2314 (26009)	A		1							55 7
X1		RETAINER: CYLINDER PISTON 8758291 (19207)	A		2							55 8
X1		SPRING HELICAL: PISTON 8758293 (19207)	A		2							55 9
X1		PISTON: AIR CYLINDER 8758295 (19207)	A		1							55 10
P-F	2520-832-8235	SEAL: AIR SHIFT CYLINDER PISTON 8758294 (19207)	A	EA	2	*	*	*	*	*	*	15 30 55 11
P-F	2520-832-7774	GASKET: AIR SHIFT CYLINDER PISTON 10913209 (19207)	A	EA	2	*	*	*	*	*	*	15 30 55 12
X1		TUBE: CYLINDER PISTON 8758292 (19207)	A		1							55 13

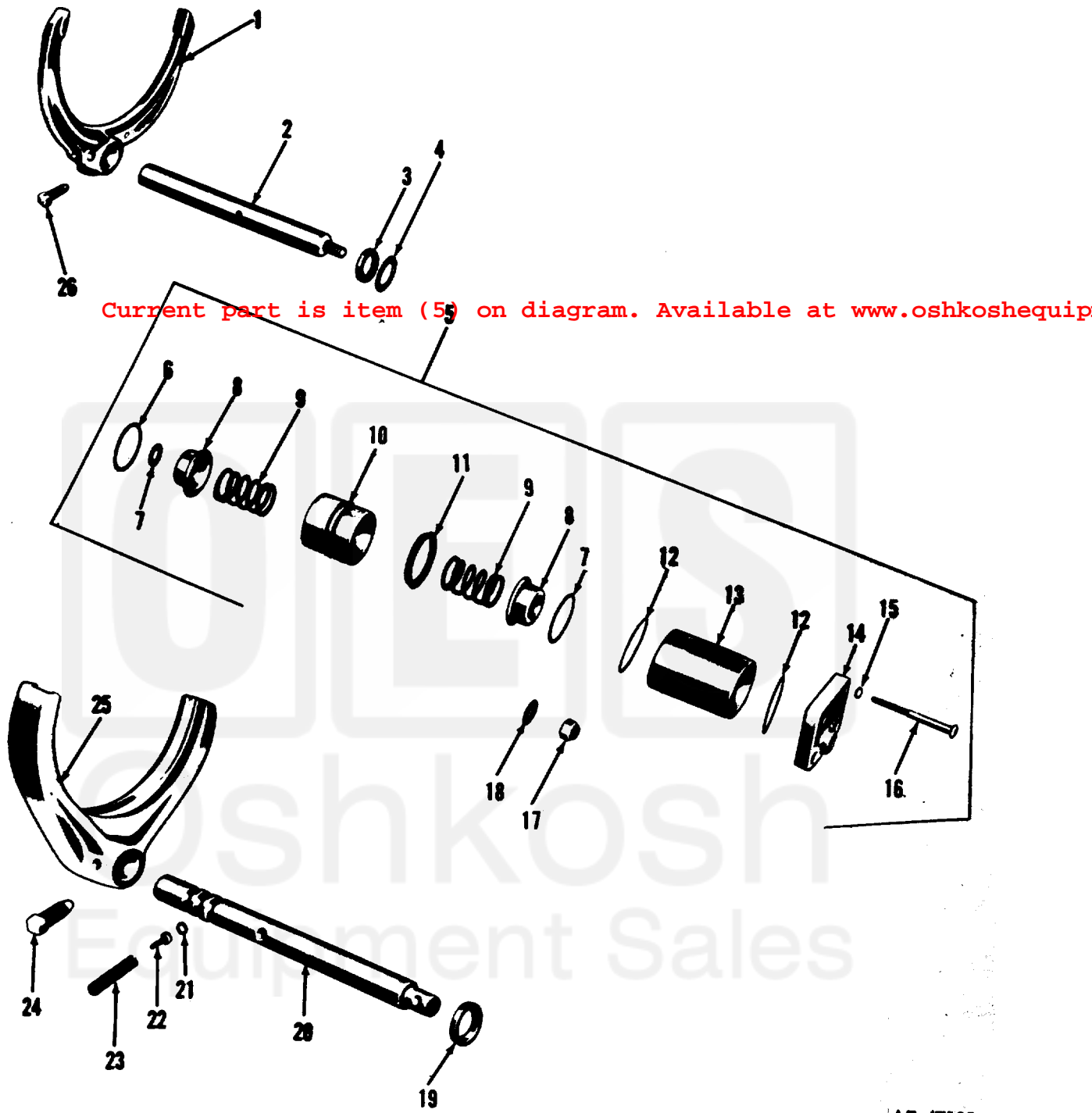

Figure 55. Input and output shifter shafts.